

SECTION A-A/SE208 (STAIR NO. 2 - LOOKING SOUTH)  
 [ SE200, SE201, SE202, SE203, SE204, SE205 ]

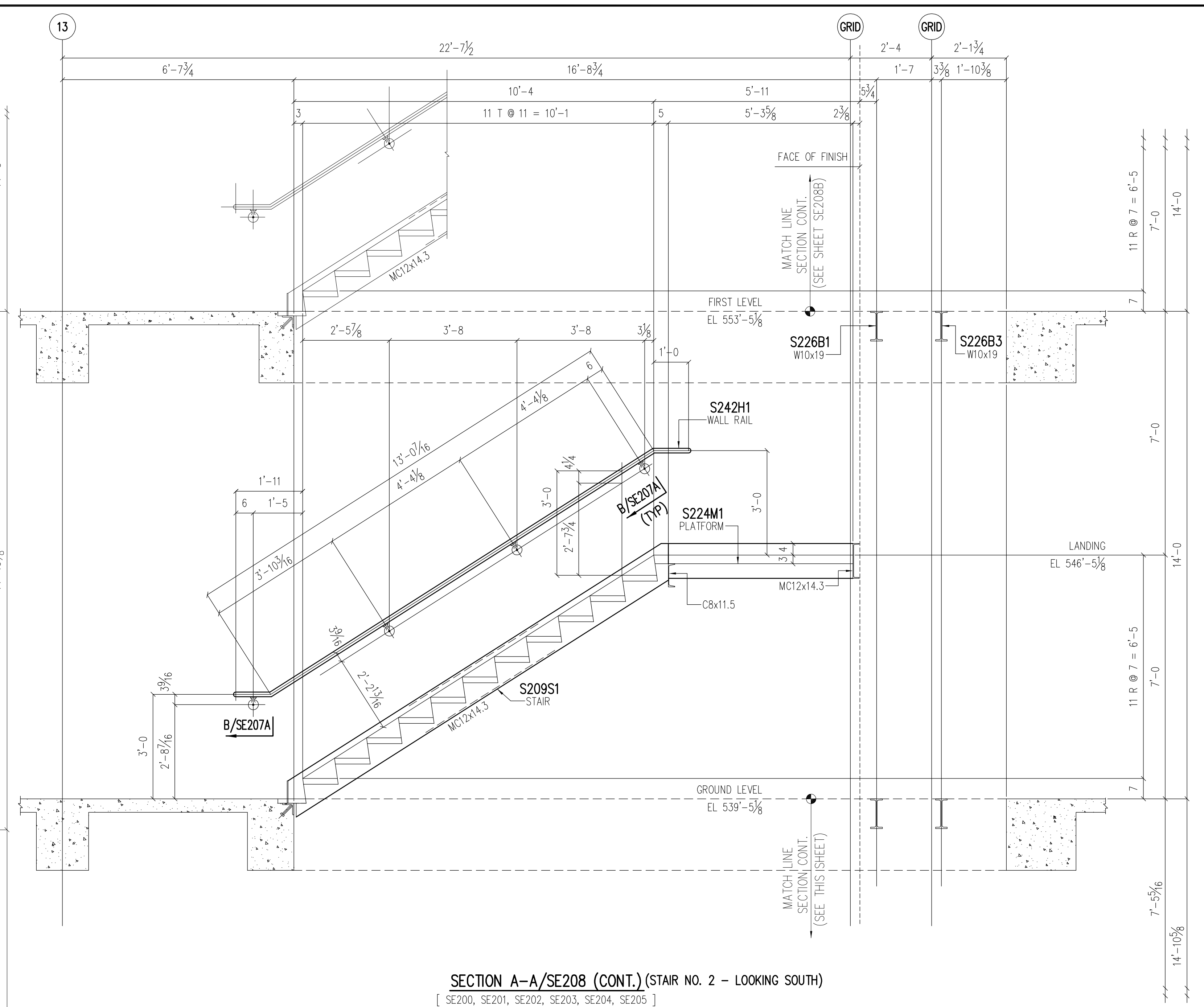

SECTION A-A/SE208 (CONT.) (STAIR NO. 2 - LOOKING SOUTH)  
 [ SE200, SE201, SE202, SE203, SE204, SE205 ]

**STAIR NOTES**  
 STRINGERS = MC12x14.3  
 HEADERS = C8x11.5  
 TREADS = 14 GA. PL W/ 2" FILL  
 LANDINGS = 10 GA. PL W/ 3" FILL  
 AND (3) C4x5.4 STIFFENERS  
 RAILING = 1 1/2" STD. PIPE

DESIGN DWG REF: A801, A802  
 ERECTION DWG REF: SE201, SE206A, SE207A, SE209, SE210, S211

PRINT RECORD					
Date	Quan.	For	Date	Quan.	For
DATE		APPROVAL			
DATE		FIELD USE			

STAIR NO. 2 - SECTIONS

Rev.	Date	Description	By

**IRWIN STEEL**  
 15740 Highway 114 ~ Justin, Texas 76247  
 Phone (817) 636-2508 ~ Fax (817) 636-2506

Job Name: STANDARD PAN STAIR IN CONCRETE FRAME  
 Location: CITY, TEXAS  
 Customer: CONTRACTOR  
 Architect: ARCHITECT

DRAWN: THX      JOB NO: 1138      SHEET NO: SE208A  
 CHECKED: HAL      CAD NO:      DATE: